



## NOR-REG Systems AS pursues a market-focused R&D program

In our world of leading-edge packaging technologies, market leadership requires the articulation and implementation of a market-driven Research & Development program. While a great number of successful packaging projects world-wide is testimony of NOR-REG Systems AS' know-how, telling the world about our capacity to deliver innovative and cost-effective business solutions may not have been a priority in the past. We were, shall we say, the "quiet achiever". Through this newsletter, we want to give you a "taste" of all the exciting projects we have been and are working on. Trusting that it will prompt a keen interest on your part to know more about them.

### Mixed/variety flavours packed in SAME CASE

Bring innovation & flexibility to your trade partners and consumers. More than 1 flavour in a case!

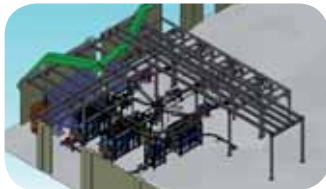

### Fully integrated Case Packer for pillow bags

Case erecting with taping of bottom flaps + bag collation + case filling + Folding of full case top flaps with tape sealing = FROM FLAT CASE IN - TO FINISHED CASE OUT.



### Bag Collator

UNIQUE bag collating mechanism - 140bpm - Quick & easy change-over. Wide bag range - Simple operation - Reliable



### High Speed Case Packer for pillow bags

Up to 200 bpm. High speed packing while retaining NOR-REG's UNIQUE characteristics!

### Huge savings on Supply-Chain costs? Can it be done?

We have designed the WP3000CD for that specific purpose + "shelf-ready" concept - Stands out on shelf.



This is a sample of the technical developments recently achieved by NOR-REG Systems AS. R&D - engine for growth through relevance and innovation! *We look forward to bringing you more news in our next newsletter.*

## Customer Service & Support

Your safety is one of our main concerns. A stable machine is key to safe work practices and optimum production output. All personnel at NOR-REG Systems AS have been trained to think and breathe around the concept of total commitment to customer service: *"Always available when a customer needs us"*.

### Service agreements

NOR-REG provides service agreements, which incorporate regular visits to our customers. Providing our customers with the tools to keep the equipment in its optimum condition is paramount to achieving safe and efficient production. As part of our agreement, our service team will perform routine machine checks, changing parts and consumables when required and will inform you of preventative maintenance procedures. Another important part of the service is to provide continuous and up-to-date electrical, mechanical and operational training.

### Benefits

A service agreement delivers some significant benefits. Our customers can plan ahead for preventative maintenance stoppages and integrate an accurate maintenance cost in their annual budget. Parts and consumables will be replaced to prevent the advent of machine failure, therefore significantly reducing the risk of downtime. **Net outcome: high efficiency = lower operating costs.** Customers with a service agreement will also be given a level of priority and will benefit from a discount on both spare parts and working hours.



Representatives of the NOR-REG Service Team

### Rebuilding and upgrading

To add new flexibility to our customers' existing/older machines, we do offer a rebuilding/overhaul service as the needs for new formats/patterns/products may have arisen. The rebuilding is also designed to deliver a higher level of efficiency. PLCs and pneumatic equipment can also be upgraded.

### Worldwide services

Our service team is set up to operate worldwide. Our Head Office is located in Norway, where the administration for all service projects is managed from. NOR-REG Systems AS also has service engineers in Sweden and Germany, ready to assist you whenever required!

- your partner in end-of-line packaging

## NOR-REG's Patented Pouch Packer = flexibility + high speed + accuracy + controlled handling of your products!

Machine efficiency and precision are key factors in product handling. The NOR-REG patented pouch packer (NPP 220-400) allows you to pack your products at high speed - up to 400 pouches per min. - in a precise and controlled handling environment.

This patented pouch packer features a special shingling device, allowing for a very accurate positioning of the pouches. After the shingling, the pouches are transported between belts, sliding all the way down to the bottom of the chute. The state-of-the-art pouch-handling mechanism prevents



them from moving and/or being displaced. The grouped pouches are then inserted "standing-up" into a waiting tray or carton. The filling process occurs while the tray is indexing in a pre-defined and servo-controlled manner. Trays can be filled with pouches organised in 1 or 2 rows. A product equalising unit is used on the infeed to optimize product distribution in the pouch. For applications running at medium to high speed, the machine is totally controlled by servo-motors.

The pouch packer is designed to receive, group and pack different types of pouches (3 & 4 side-sealed pouches, Doypack). The pouches are packed "standing" and this in trays or recyclable containers. The machine can be supplied in the following configurations:

- one-lane
- one-lane with twin head
- two-lanes
- two-lanes with twin head

Capacity: Up to 400 pouches per minute per lane.

The NOR-REG manufacturing and quality standards are well-established and proven in many production environments. Experience shows that very little maintenance is required to keep the equipment to its optimum level of performance. The machine also offers a great deal of flexibility and can be adapted to suit many applications.

## Reducing operating costs: The impact of minimisation of equipment downtime

The Tine Heimdal company (a Norwegian dairy producer) implemented in April this year a 6 hour/day working regime. To date, the results have spoken for themselves: a drop in sick-leave claims and increased production outputs (just to name a few) have lead to a 5% reduction in operating costs!

To achieve this outstanding result, they had to be able to count on the reliability of their production equipment. The machines need to produce continuously with a strict minimum amount of downtime. Furthermore, as each production line integrates a number of different machines, everyone of them requires a very high level of efficiency to deliver an acceptable line output.

NOR-REG Systems AS would like to congratulate Tine Heimdal for this great result! We are proud to be associated with such a reputable organisation and to have been able to make a contribution in their quest for reduced operational costs by being their trusted supplier of end-of-line packaging equipment!

## Exhibitions 2008

We look forward to meeting you at the following exhibitions in 2008:



**24.-30. April**, INTERPACK PROCESSES & PACKAGING 2008,  
Düsseldorf, Germany  
[www.interpack.com](http://www.interpack.com)



**30. September-03. October**, INDUSTRIËLE WEEK 2008,  
Jaarbeurs Utrecht, The Netherlands  
[www.macropak.nl](http://www.macropak.nl)



**24.-25. September**, EMPACK 2008, Lillestrøm, Norway  
**21.-22. October**, PACK & EMBALLAGE, Stockholm, Sweden  
[www.easyfairs.com](http://www.easyfairs.com)